



Drying cabinets

Steelco drying cabinets are **available in several configurations** from full width shelves dedicated to instruments, equipment and general items to mixed solutions for anaesthesia items and instruments.

Blanket warming version available as well.

Cabinets are available in single door or double door pass through versions with glass doors for a rapid visual inspection of the stored items.

Separate drying of anaesthetic and instrument accessories increases the throughput capacity of a washer disinfector of a third. Drying cabinets can accept a load volume of more than 2 units of washer disinfectors.



ID 300

Instrument drying cabinet



- capacity up to nr. 18 DIN 1/1 trays on 9 removable shelves, supplied with nr. 8 shelves.



AD 400

Instrument, anaesthesia bags and hanging hoses mixed drying cabinet

Composition

- up to nr. 3 AN cassettes for a total capacity of 36 anaesthesia hoses
- up to nr. 9 DIN 1/1 trays capacity on 9 removable shelves
- or
- up to nr. 18 anaesthesia bags capacity
- up to nr. 9 DIN 1/1 trays capacity on 9 removable shelves

Supplied with nr. 8 shelves and nr. 3 AN cassettes.



BD 500

Blankets warming cabinet

- 4 removable shelves for blankets (standard). Shelves can be added and adjusted for different sizes of load.

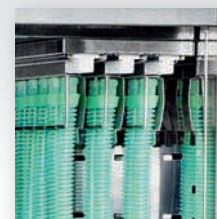

standard

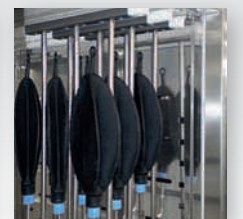

option

General key features

- Insulated double walled AISI 304 stainless steel construction that grants the exterior surface temperature does not exceed 49°C (120°F). Temperature of tempered glass door does not exceed 49°C (120°F).
- Visual “open door” indicator. Lockable door.
- LED display, programmable for °C and °F, provides control and heater-on information for easy serviceability, temperature and time settings are control password protected to prevent unauthorized changes.
- Drying temperature settable from ambient to 80°C (176°F). Temperature alarms is disabled when door is open and for the time required to re-equilibrate temperatures in cabinet after door is closed. Temperature setting from 1 up to 999 min or continuous. Once the selected temperature is attained, it will be controlled throughout within 5.5°C (10°F) of the selected temperature. Overheat protection will shut the heater off with audible alarm for operator
- Indirect UV air treatment during the whole cycle. Optional.
- Drying circuit with double fan combined with fast connectors (optional).
- Flashing air flow visual alarm indicators if either drying circuit fails.
- Air flow alarm with re-settable audible alarm, (flashing alarm indication remains until the air flow is restored).
- HEPA filtration on drying circuit. Monitoring for HEPA filter and indicator on panel advising when replacement is required.
- Control components positioned in top front position for convenient service access. Easy removal of fans, heater elements and control boards.

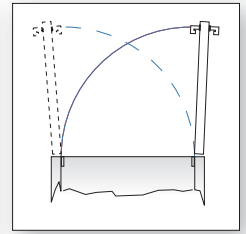
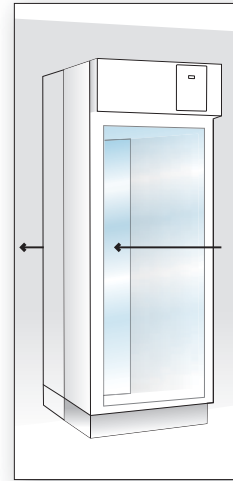

Lockable doors are reversible and configurable right or left opening also during installation.
Double door pass through version available.

Optional

- nr. 8 or 9 air fast connections
- extra shelves with rails
- UV air treatment
- Humidity sensor
- ST2 printer

Dimensions and connections

Standard electrical connection (International)	230V/~ /50Hz
Optional electrical connection (North America)*	220V/~ /60Hz
Power ID 300 - BD 500	1700 W
Power AD 400	1750 W

*other electrical connections also available as optional

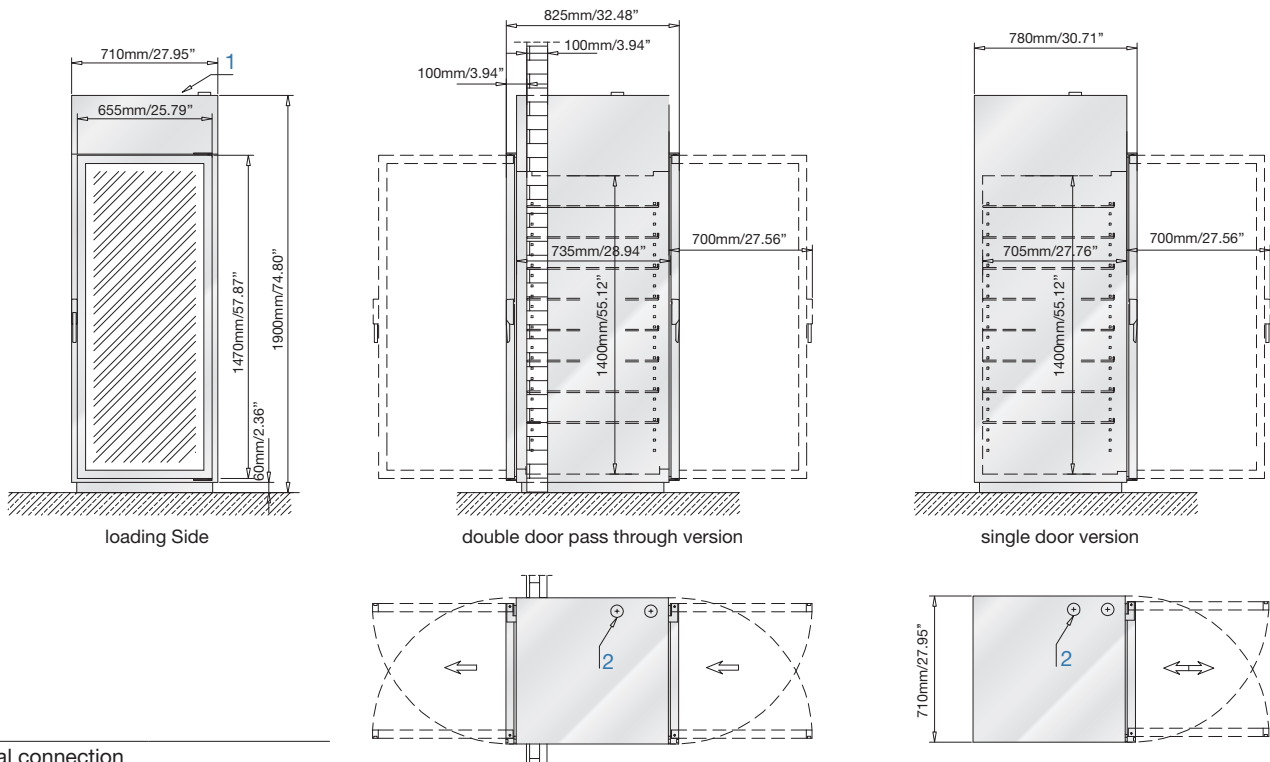

- 1 Electrical connection
- 2 Breather pipe Ø 40 mm /1.57"